

INFINITY MATRIX 120 ARGB

MANUAL

BELIEVE IT

www.Antec.com

All rights reserved. Specifications are subject to change without prior notice. Actual products and accessories may differ from illustrations. Omissions and printing errors excepted. Content of delivery might differ in different countries or areas. Some trademarks may be claimed as the property of others.

V2.2

©1986 – 2026 Antec Inc. All rights reserved.

1 CONTENTS

120MM FAN

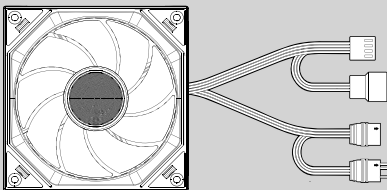

ANTI-VIBRATION PAD



(*Includes four self-adhesive anti-vibration pads for easy installation.)

FAN SCREW



RADIATOR SCREW

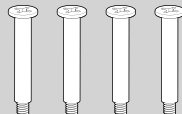

2 FAN INTRODUCTION

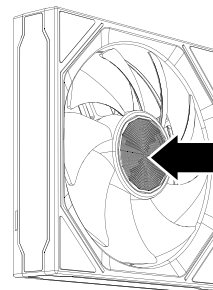

AIR-IN

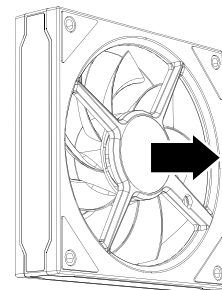

AIR-OUT

3 FAN DIMENSIONS

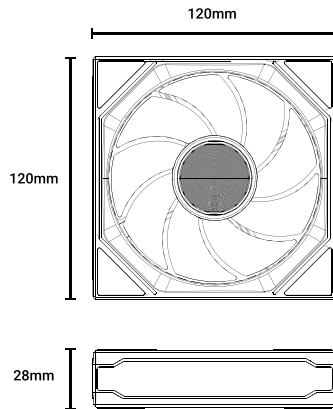

4 FAN CONNECTION

- Connect to the Motherboard

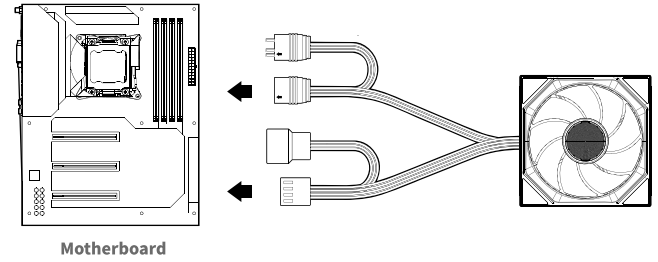

**Supports motherboards or controllers with ARGB control for 21 LEDs.*

5 FAN INSTALLATION

- Installation on Radiator

1. Secure the fan to the radiator using the provided radiator screws.
2. Attach the included anti-vibration pads to the front side of the fan.

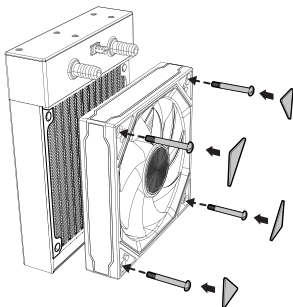

- Installation on Chassis

1. Attach the included anti-vibration pads to the front side of the fan.
2. Secure the fan to the chassis using the provided fan screws.

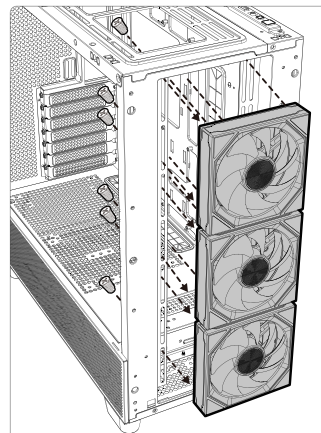

FRONT

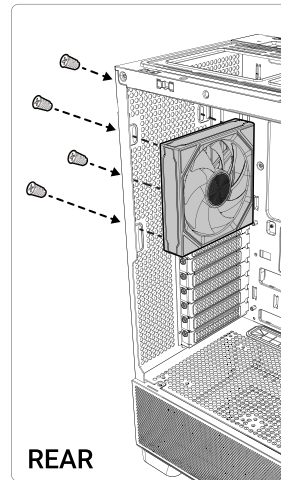

REAR

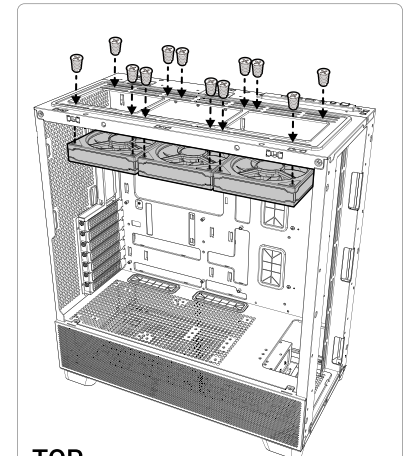

TOP